

DECK PLANS

# ABOARD STAR BREEZE

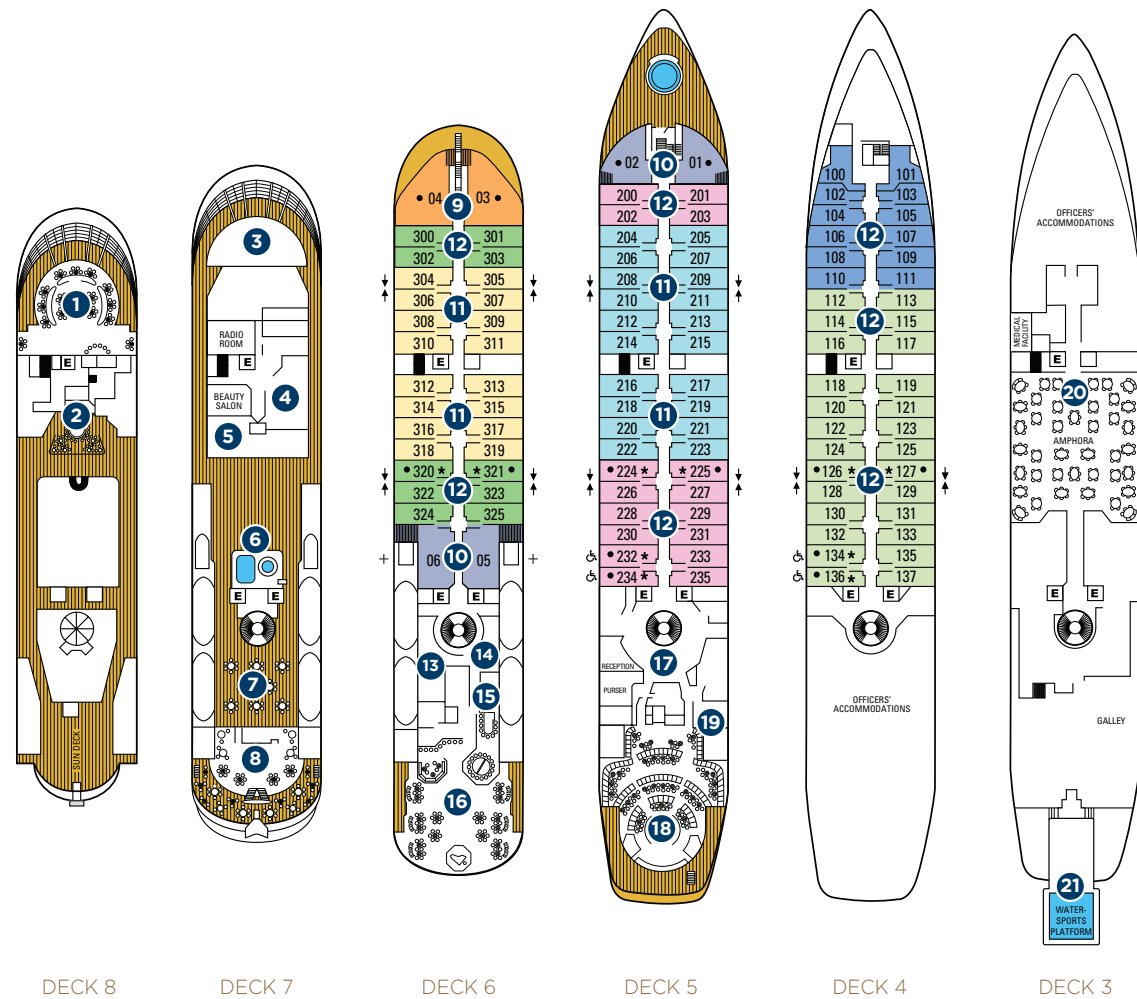

ONBOARD SPACES

- |                                      |                            |                         |
|--------------------------------------|----------------------------|-------------------------|
| 1 Yacht Club                         | 9 Owner's Suites           | 17 Reception            |
| 2 Star Bar                           | 10 Classic Suites          | 18 Lounge               |
| 3 Bridge                             | 11 Balcony Suites          | 19 Screening Room       |
| 4 WindSpa                            | 12 Ocean View Suites       | 20 AmphorA Restaurant   |
| 5 Fitness Center                     | 13 Signature Shop          | 21 Watersports Platform |
| 6 Counter-current pool and whirlpool | 14 Library/Business Center |                         |
| 7 Courtyard                          | 15 Casino                  |                         |
| 8 Veranda/Candles                    | 16 Compass Rose            |                         |

+ RESTRICTED VIEW  
 ↓ ADJOINING SUITES  
 E ELEVATOR  
 • ONE QUEEN SIZE BED ONLY (no twin option)  
 \* SHOWER ONLY  
 ♿ MODIFIED ACCESSIBLE SUITES  
 Feature a full-size bed (no twin option)  
 Suites 134, 136, 232 & 234, are modified accessible, shower only with a small lip into shower, a step into the bathroom with a portable ramp, standard interior and exterior doorways.

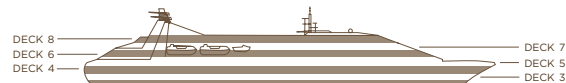

- OWNER'S SUITE (OW)
- CLASSIC SUITE (CS)
- BALCONY SUITE 1 (BS1)
- BALCONY SUITE (BS)
- OCEAN VIEW SUITE 3 (S3)
- OCEAN VIEW SUITE 2 (S2)
- OCEAN VIEW SUITE 1 (S1)
- OCEAN VIEW SUITE (S)

- Access to board ship is via stairs only.
- Access to/from outside deck may require assistance with doors and thresholds.

ALL SUITE YACHT

**Owner's Suites (OW):**  
575 square feet (54 square meters)

**Classic Suites (CS):**  
Forward Suites, 01 and 02 –  
530 square feet (49 square meters)

Midship Suites, 05 and 06 –  
400 square feet (37 square meters)

Suites with 3rd berths –  
05 and 06

**Balcony Suites (BS, BS1):**  
277 square feet (26 square meters)

Suites with 3rd berths –  
204-205, 222-223

**Ocean View Suites (S, S1, S2, S3):**  
277 square feet (26 square meters)

Suites with 3rd berths –  
112-115, 300-301

**Modified Accessible Suites:**  
277 square feet (26 square meters),  
(Suites 134, 136, 232, 234).



Owner's Suite, Forward



Classic Suite, Midship

SHIP FACTS

**GUEST CAPACITY:** 212

**GUEST DECKS:** 6

**CREW MEMBERS:** 140

**LENGTH:** 440 feet  
(134 meters)

**BEAM:** 63 feet (19 meters)

**DRAFT:** 16.5 feet (5 meters)

**CRUISING SPEED:** 15 knots

**PROPULSION:** Twin propeller, driven by four Bergen marine diesel engines

**TONNAGE:** 9,975 grt  
(gross registered tons)

**SHIP'S REGISTRY:** Bahamas



Classic Suite, Forward

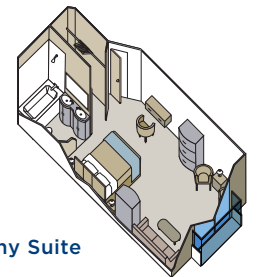

Balcony Suite

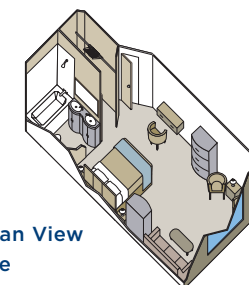

Ocean View Suite

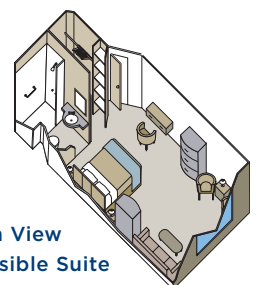

Ocean View Accessible Suite